



Norbord®

make it better



CaberfixPro®

www.norbord.co.uk

# Caberdek® and CaberfixPro®

## Step by step application guide

### Step 1. Adhesive I-joist application

Apply a 6mm bead of Caberfix Joint & Joist adhesive to the top of the joist or I-joist, using a skeleton gun. Use Caberfix Joint & Joist adhesive on joists and noggins in the area that is about to be directly laid.

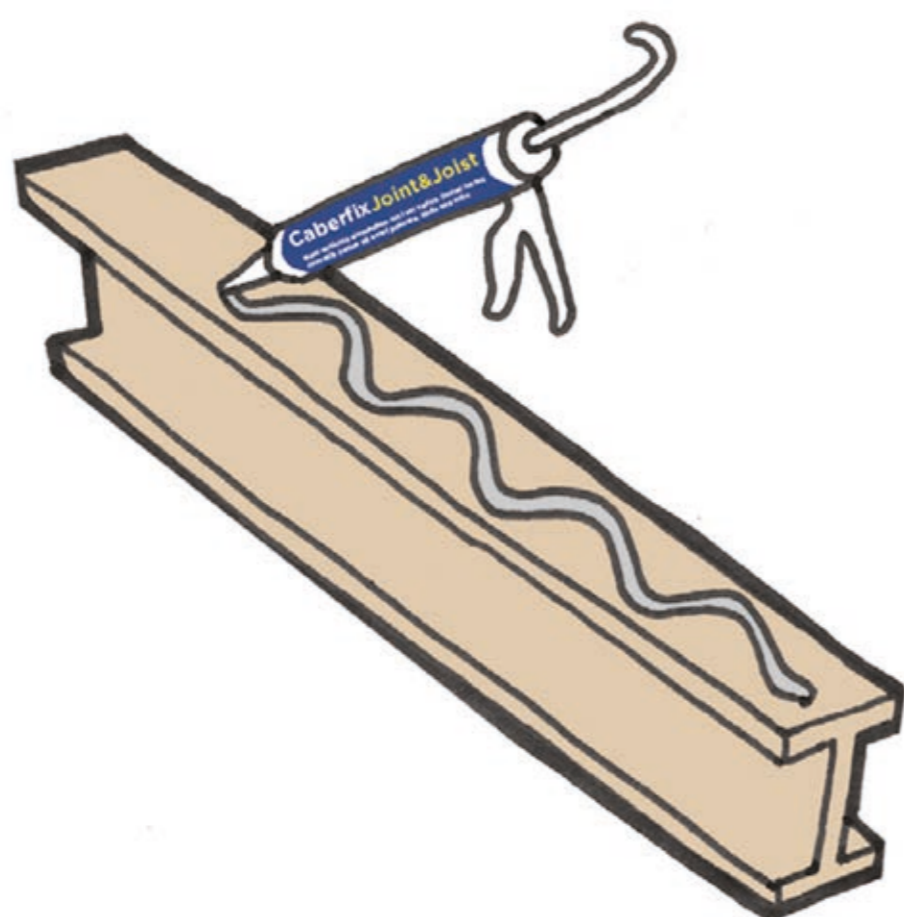

### Step 2. Perimeter panel fixing

Panels should be fixed at perimeter using annular ringshank nails or screws at 200-300mm centres. Fix flush or just below surface 25mm from edge of board.

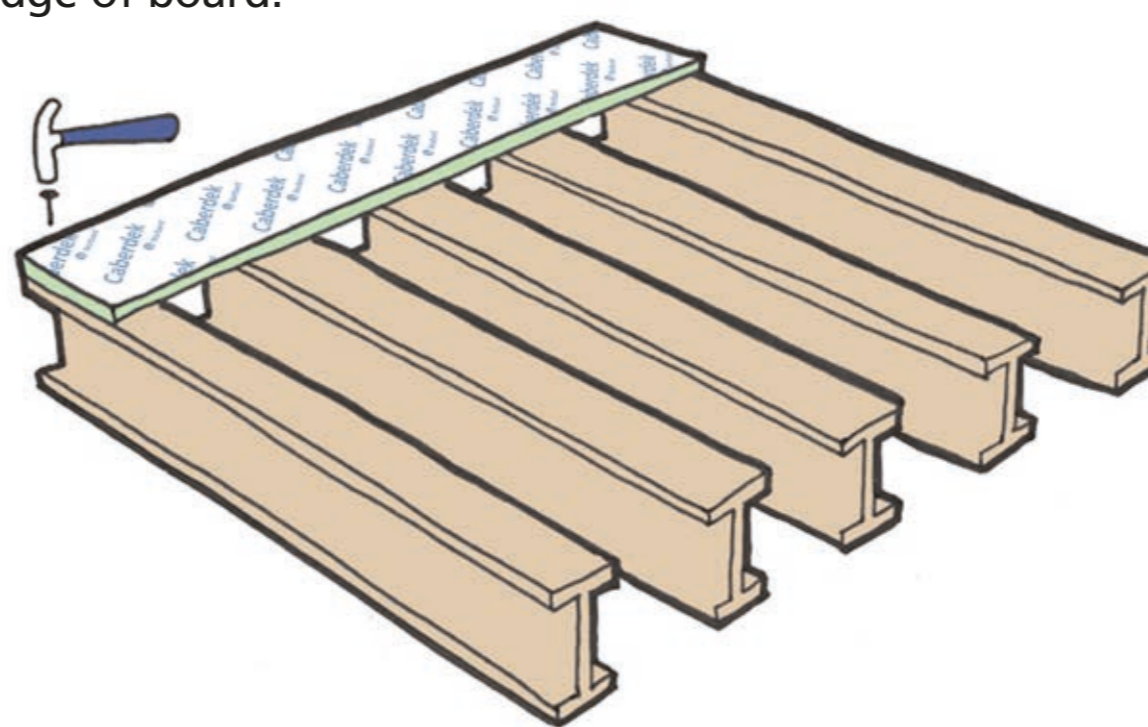

### Step 3. Adhesive tongue & groove application

A liberal application of Caberfix T&G Adhesive D3 PVA should be made to both the tongue and groove of the profile to ensure that the entire joint is bonded.

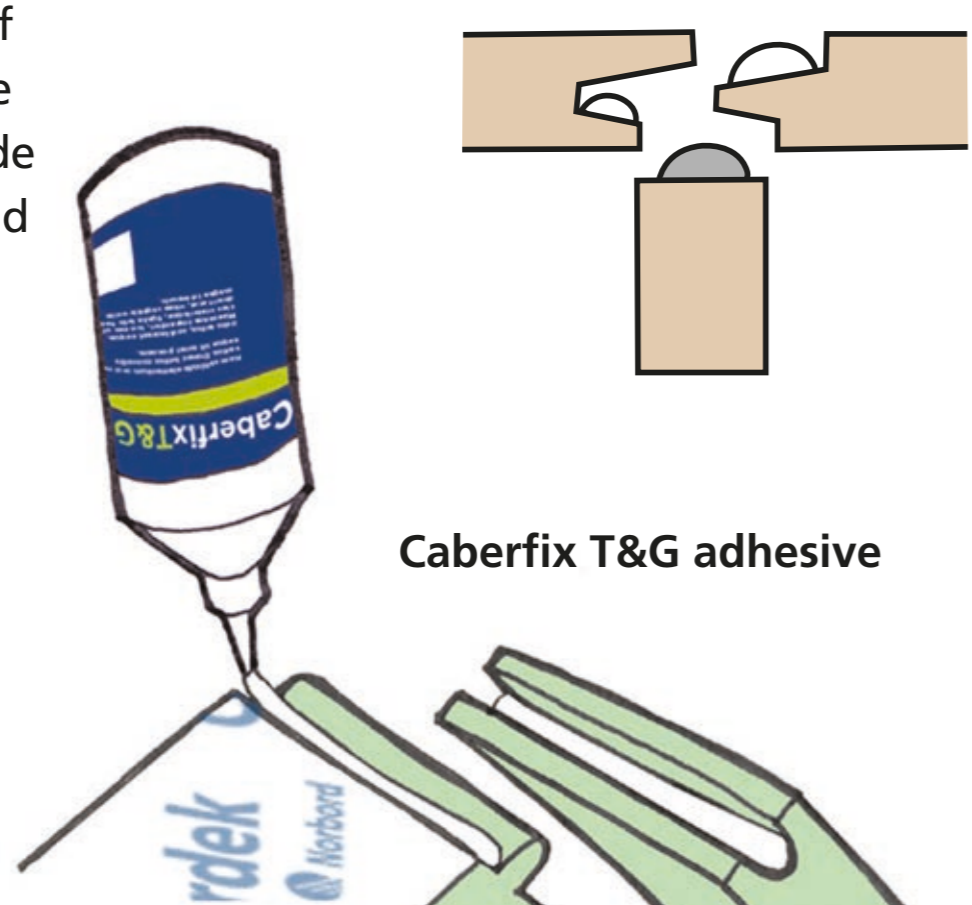

### Step 4. Panel fixing

Continue laying boards in a staggered format. Panels may be secretly nailed through the tongue at T&G joints. For 22mm Caberdek at 600mm centres only use 5 fixings per 2400mm panel.

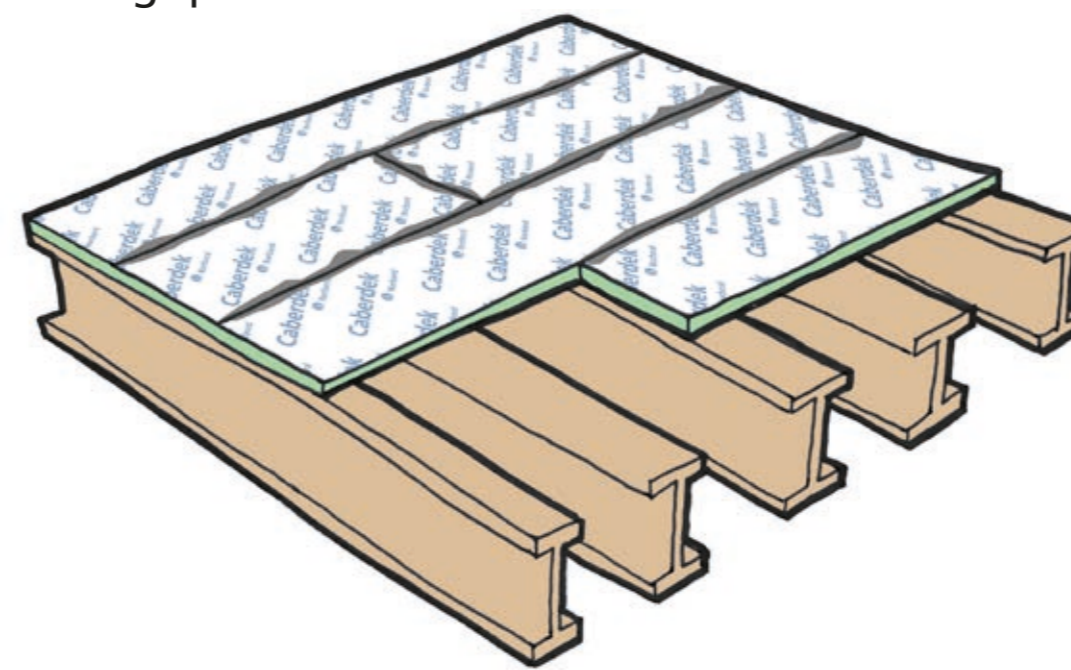

### Step 5. Taping

Immediately after a run of panels have been fixed, all board joints, nail runs and exposed edges around the perimeter should be sealed using Caberfix tape or in harsh conditions use Caberfix X-treme tape.

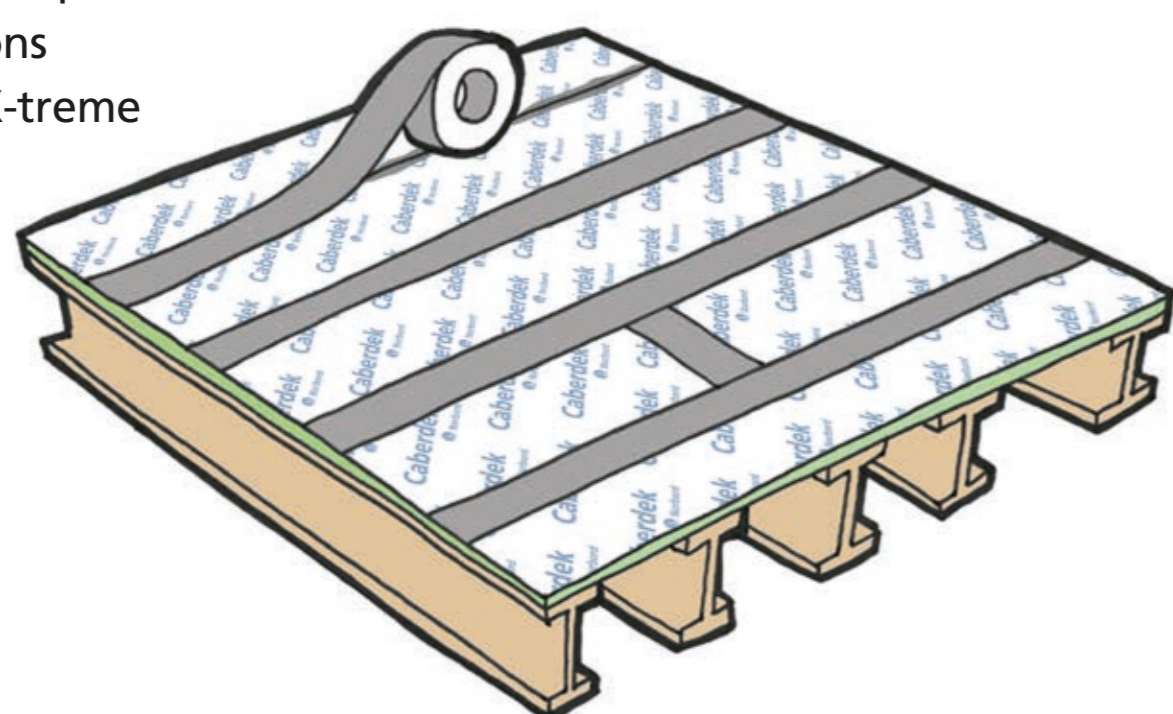

### Step 6. Clean down

When all construction and decoration work is complete and the building is weather tight, the deck should be cleaned down and peel-off film removed by pulling slowly but firmly from the short end.

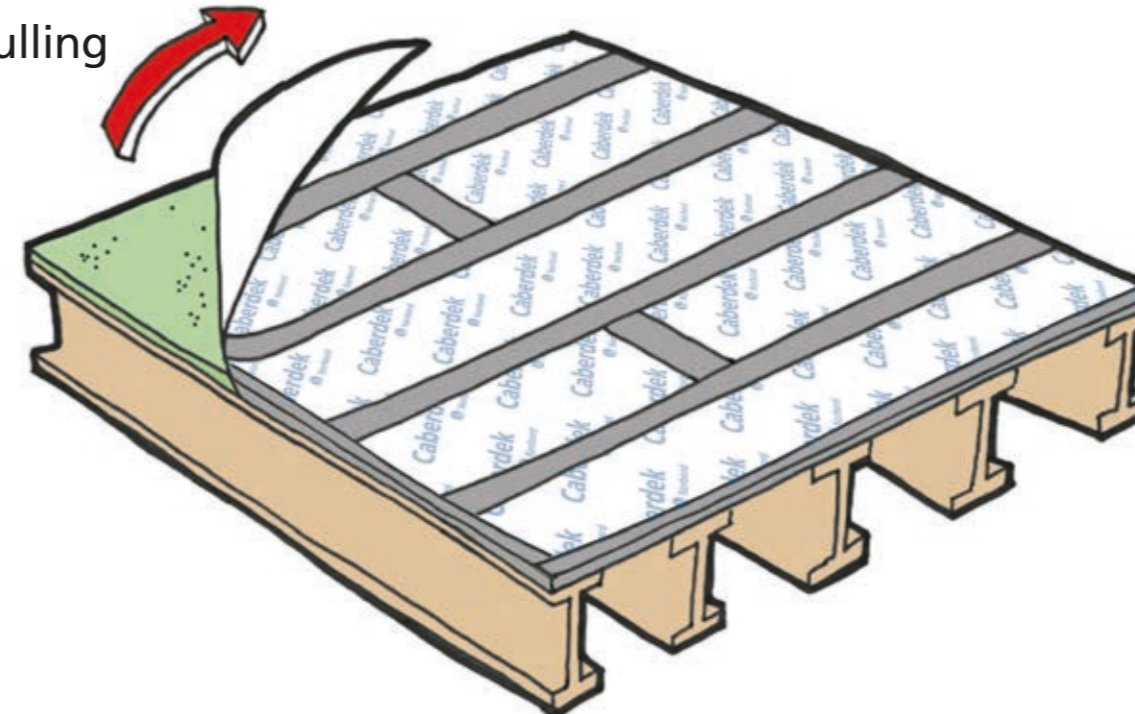

## Also available from Norbord

**Caberfix X-treme** tape (a highly durable acrylic tape designed specifically for harsh winter conditions).

- ✓ Works in colder conditions than you can!
- ✓ Will work to minus 21 degrees
- ✓ Bonds even in damp conditions
- ✓ Scuff resistant so tape won't lift when walked over
- ✓ Will not crack or break in harsh conditions.

## Storage instructions

For best results tapes and adhesives should be stored between 5-25°C and should be protected from freezing. If working onsite in winter conditions we suggest storage of fixings in site office.



Scan QR code for video instructions

## Features and benefits

- ✓ Safe working platform – slip resistant film and assists with fall protection
- ✓ Withstands high site traffic – impact, puncture and tear resistant film
- ✓ Film is easily removed – saves clean up costs and time
- ✓ All systems are fully BBA approved – can be exposed to the elements for up to 42 days.



www.norbord.co.uk